

**SITE PLAN**

1. Show size and location of proposed garage
2. Show distance to side property line
3. Show distance to rear property line
4. Show lot dimensions and shape of lot
5. Show all existing buildings

**All part of the building must be inside the property line.**

An attached garage is classified as part of the house.

A minimum distance of 4' from the property line is required.

**CITY OF MELVILLE**  
**PUBLIC WORKS & PLANNING SERVICES**  
 Box 1240, 100 Brunswick Street  
 Melville SK S0A 2P0

Office Hours:  
 8:00am—4:00pm  
 Monday—Friday

Telephone:  
 306-728-6865

Fax:  
 306-728-5832

E-mail:  
[publicworks@melville.ca](mailto:publicworks@melville.ca)

Social Media:  
[www.melville.ca](http://www.melville.ca)  
[www.facebook.com](http://www.facebook.com)

*This pamphlet has no legal status and cannot be used as an official interpretation of the various codes and regulations currently in effect. The City of Melville accepts no responsibility to persons relying solely on this information.*



# Building an Attached Garage/ Carport



# ATTACHED GARAGE

## Checklist

How are trusses constructed?  
\_\_\_\_\_

How are trusses attached to dwelling?  
\_\_\_\_\_

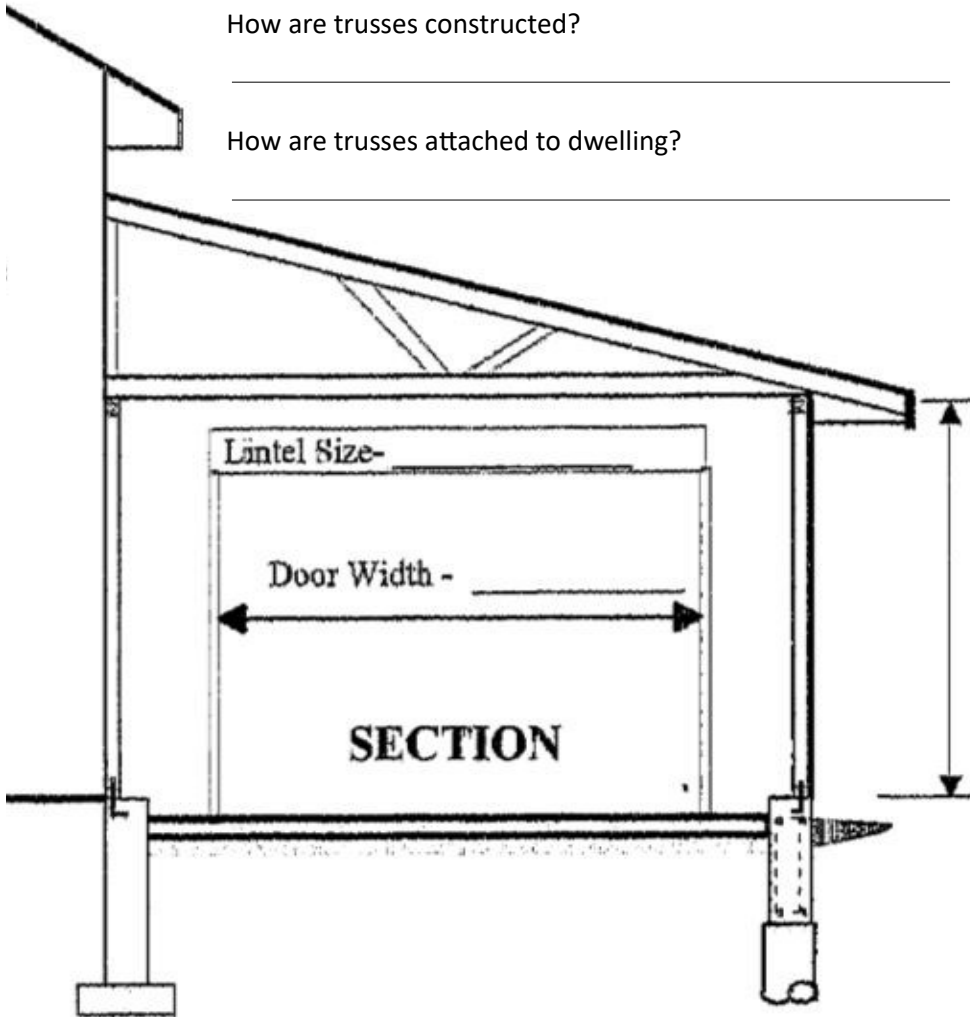

Foundation Wall

Grade Beam & Piles

Foundation Height \_\_\_\_\_

Pile Diameter \_\_\_\_\_

Wall Thickness \_\_\_\_\_

Pile Depth \_\_\_\_\_

Footing Size: Width \_\_\_\_\_

Beam Size: Width \_\_\_\_\_

Thickness \_\_\_\_\_

Height \_\_\_\_\_

Rebar: In Pile \_\_\_\_\_

In Beam \_\_\_\_\_

Pile-to-Beam \_\_\_\_\_

### Roof:

Type of roof shingles \_\_\_\_\_

Type & thickness of roof sheathing \_\_\_\_\_

Spacing of roof trusses \_\_\_\_\_

Slope of roof \_\_\_\_\_

Width of overhang \_\_\_\_\_

### Exterior Wall:

Type of siding \_\_\_\_\_

Type of Bldg. Paper/House Wrap \_\_\_\_\_

Type & thickness of wall sheathing \_\_\_\_\_

Size and spacing of studs \_\_\_\_\_

Height of wall \_\_\_\_\_

Type, size and spacing of anchor bolts \_\_\_\_\_

### Wall Between House and Garage:

N/A

Wall to be constructed as a vapour tight separation.

No openable windows permitted.

Construction must resist the passage of gas and exhaust fumes from entering the dwelling.

### Slab:

Thickness of slab \_\_\_\_\_

Type of sub base \_\_\_\_\_

Sloped outdoors \_\_\_\_\_

Construction Joint between house and slab \_\_\_\_\_

### CODE REQUIREMENTS

#### Door into House:

Weather stripped

Self-closer

Deadbolt Lock

Blocked at lock-height to frame

Hinges secured to solid wood frame

**Note:** Air duct systems cannot be interconnected with other parts of the dwelling unit.

**Note:** The foundation must extend to the same depth or greater than the house foundation.